

Unofficial diagram of the crime scene containing blood evidence described in [The Case for Ayla](#)

29 Violette Avenue, Waterville, Maine - First Floor (not to scale)

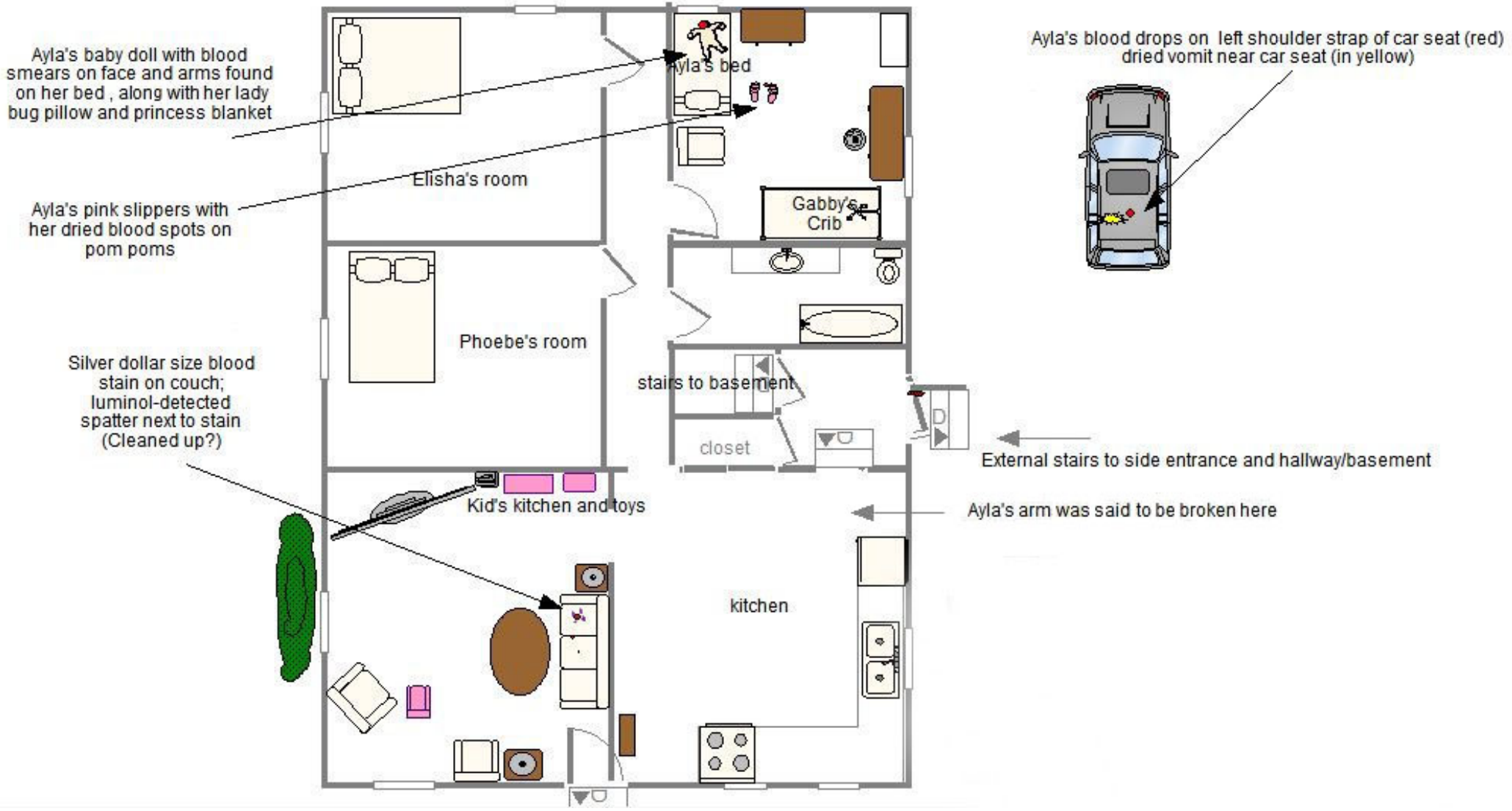

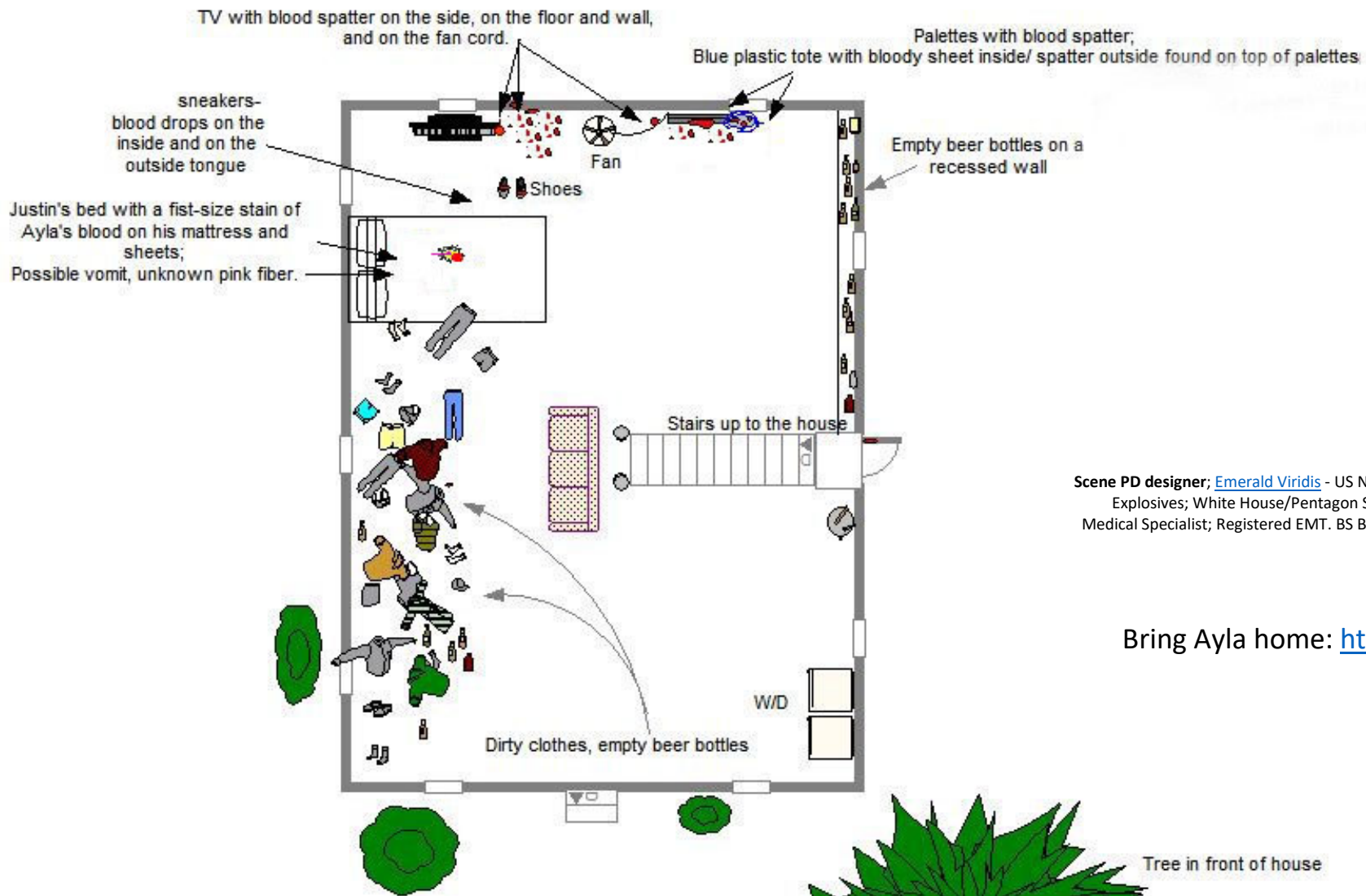

Scene PD designer; [Emerald Viridis](#) - US Navy- Aviation Life Support Systems and Explosives; White House/Pentagon Staff Washington DC. US Army- Combat Medical Specialist; Registered EMT. BS Biological Sciences and Marine Sciences.

Bring Ayla home: <https://pressjustin.com/>